

# Customer Information Sheet

IF IN DOUBT - ASK



NOT TO SCALE

THIRD ANGLE PROJECTION

ALL DIMENSIONS IN mm

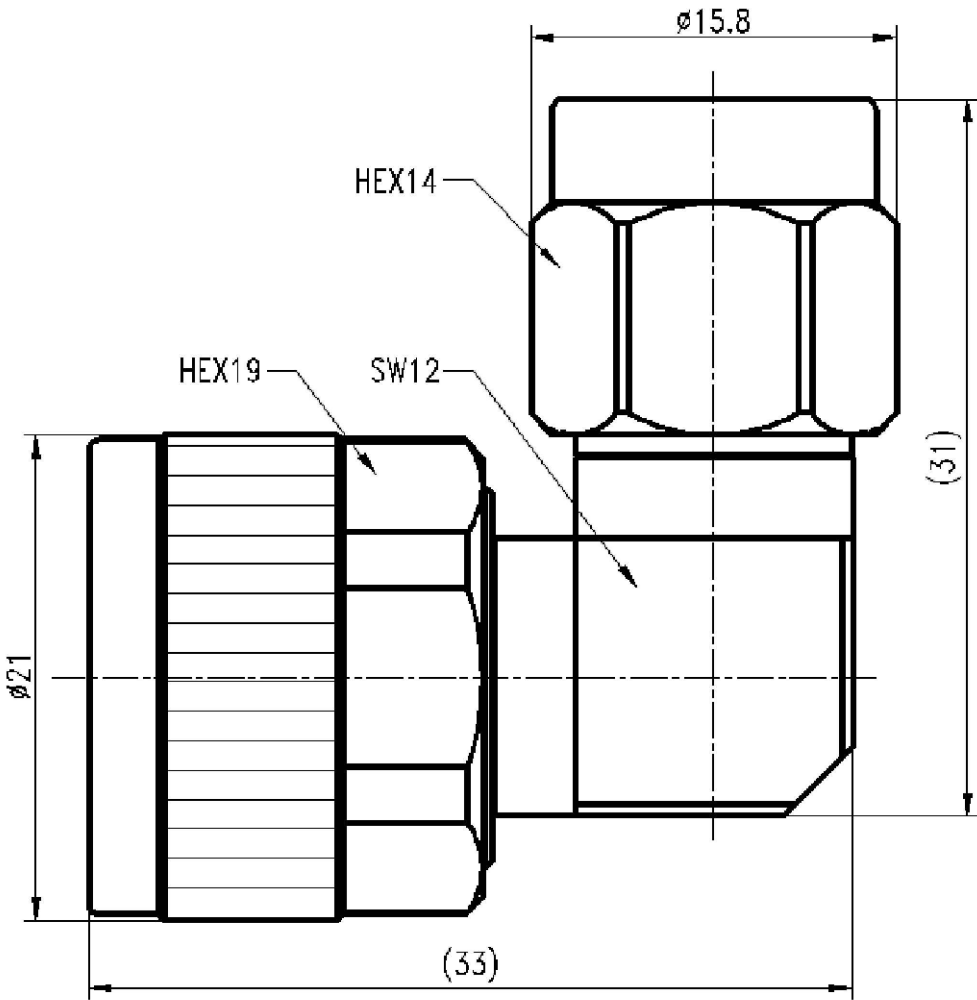

## Material and coating

|                 |   |
|-----------------|---|
| Outer conductor | Stainless steel <u>passivation</u>                |
| Inner conductor | Beryllium copper gold plating & Gold-plated brass |
| Medium body     | PEI&PTFE  |

## Electrical performance

|                              |  |
|------------------------------|--|
| Characteristic impedance     | 50Ω  |
| Usage frequency              | 10MHz-18GHz                                  |
| Insulation resistance        | ≥5000MΩ                                      |
| Dielectric withstand voltage | 2000Vrms                                     |
| Contact resistance           | Central conductor ≤3mΩ, Outer conductor ≤5mΩ |
| VSWR                         | ≤1.25  |
| Insertion loss               | ≤0.1 √f(GHz)dB                               |

NAME ISS. DATE CN/CO

APPROVED:

CHECKED:

DRAWN:

# HARWIN

www.harwin.com

## TOLERANCES

X. = ±1mm  
X.X = ±0.50mm  
X.XX = ±0.10mm  
X.XXX = ±0.01mm

ANGLES = ±5°  
UNLESS STATED

THIS DRAWING AND ANY INFORMATION OR DESCRIPTIVE MATTER SET OUT HEREON ARE CONFIDENTIAL AND COPYRIGHT PROPERTY OF THE HARWIN GROUP AND MUST NOT BE DISCLOSED, LOANED, COPIED OR USED FOR MANUFACTURING, TENDERING OR FOR ANY OTHER PURPOSE WITHOUT THEIR WRITTEN PERMISSION.

## MATERIAL & FINISH:

TITLE: TNCA Type, Jack - Jack, Curved Adapter, 50 ohm

DRAWING NUMBER:  
MMCN-2101BK-RA-001

SHT  
1  
OF  
1