

Customer Information Sheet

IF IN DOUBT - ASK



NOT TO SCALE

THIRD ANGLE PROJECTION

ALL DIMENSIONS IN mm

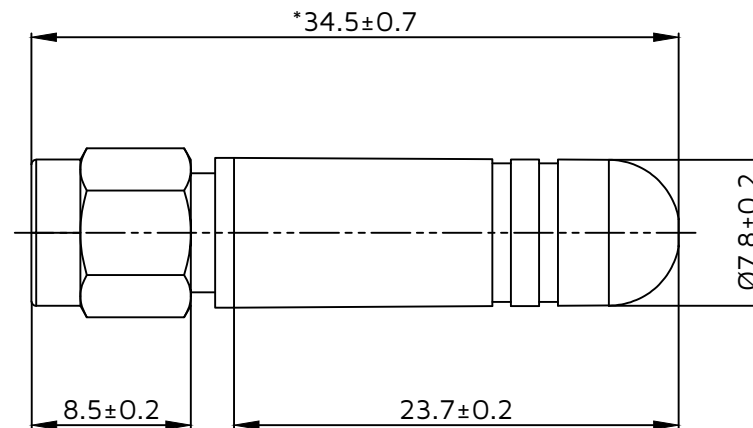

NOTE:

- Frequency 2.4~2.5GHz 5~6GHz 6~7.125GHz
- Peak Gain(Max): 2.4~2.5GHz 3.4dBi
5~6GHz 6.0dBi
6~7.125GHz 4.5dBi
- The size marked with " * " is the key inspection size.
- Operating with matching: -40°C~85°C
- Storage with matching: -40°C~85°C
- Impedance with matching: 50Ohms
- Connector type: SMA(MALE)
- Waterproof : IP66
- The horizontal tension of the sheath and the joint shall meet: 30N Min, and the vertical thrust shall meet: 30N Min
- Materials comply with RoHS and halogen-free standards (Cl < 900ppm Br < 900ppm Cl+Br < 1500ppm)

| | | | |
|-----|--------------------|------|--------------|
| 4 | HANSBANG 8013 GLUE | | 0.02g |
| 3 | ANTENNA JACKET | 1PCS | BLACK |
| 2 | SPRING | 1PCS | |
| 1 | SMA CONNECT (MALE) | 1PCS | GOLD PLATING |
| NO. | NAME | Q'TY | NOTE |

| | | | |
|------------------------|------|---------|-------|
| KC | 1 | 03JUL25 | -- |
| NAME | ISS. | DATE | CN/CO |
| APPROVED: WALKER/MEIZY | | | |
| CHECKED: THIRI | | | |
| DRAWN: KC | | | |

HARWIN

www.harwin.com

TOLERANCES

X. = ±1mm
X.X = ±0.50mm
X.XX = ±0.20mm
X.XXX = ±0.01mm

ANGLES = ±5°
UNLESS STATED

THIS DRAWING AND ANY INFORMATION OR DESCRIPTIVE MATTER SET OUT HEREON ARE CONFIDENTIAL AND COPYRIGHT PROPERTY OF THE HARWIN GROUP AND MUST NOT BE DISCLOSED, LOANED, COPIED OR USED FOR MANUFACTURING, TENDERING OR FOR ANY OTHER PURPOSE WITHOUT THEIR WRITTEN PERMISSION.

MATERIAL & FINISH:

TITLE:

2.4GHz Wi-Fi Stubby Antenna,
Straight SMA Male Connector,
Indoor Use

DRAWING NUMBER:

MMANT-1301000-SM1-000

SHT
1
OF
1